

NOTES:
 1. DUE TO OUR CONTINUOUS IMPROVEMENT PROGRAM, ALL MODELS AND SPECIFICATIONS ARE SUBJECT TO CHANGE WITHOUT NOTICE.

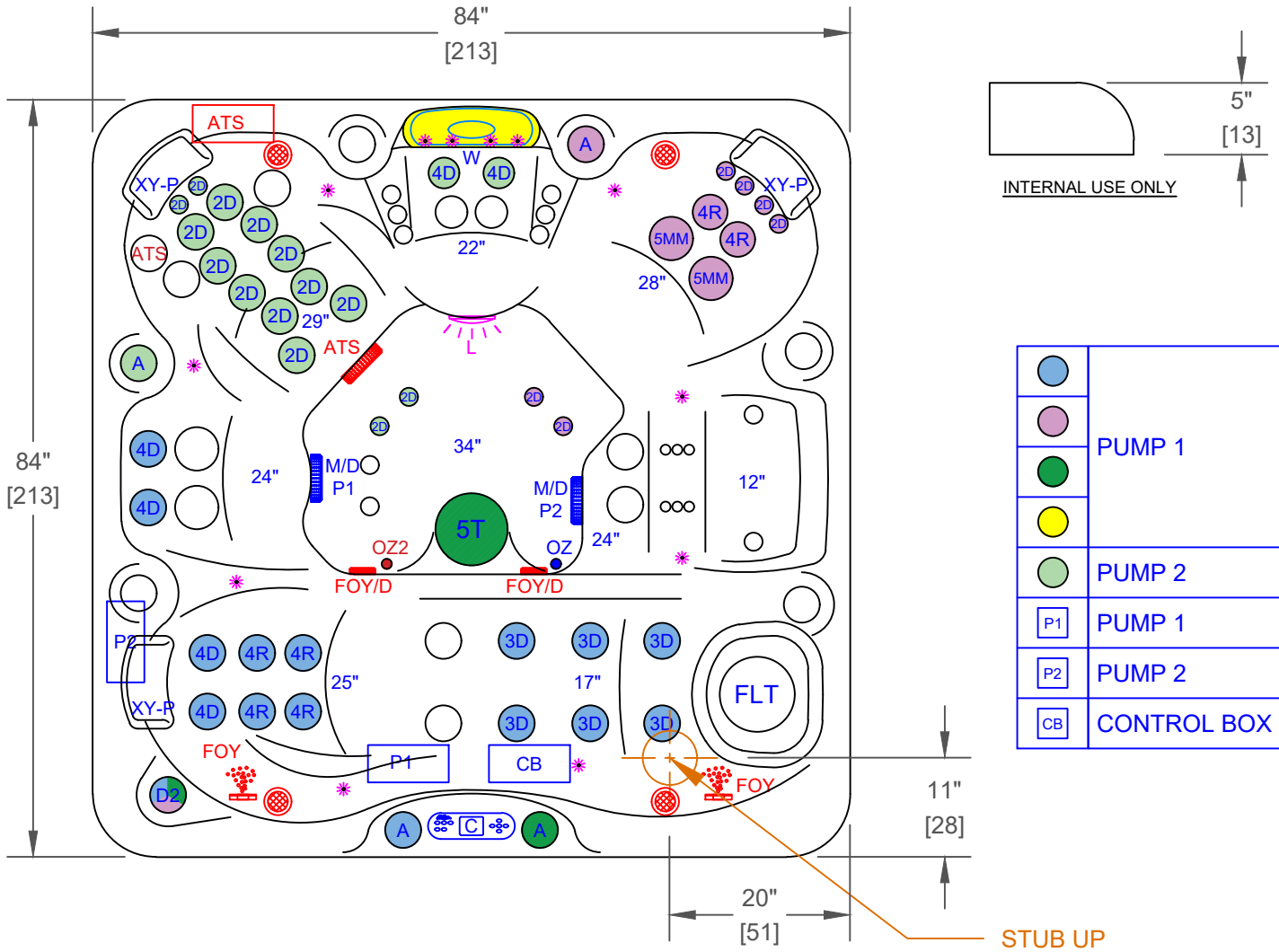

| | |
|--|-------------|
| | PUMP 1 |
| | |
| | |
| | |
| | PUMP 2 |
| | PUMP 1 |
| | PUMP 2 |
| | CONTROL BOX |

| EC-740L - LEGEND | | | |
|------------------|--|---------------------|------|
| SYMB. | DESCRIPTION | PART NUMBER | QTY. |
| 2D | 2" CLUSTER STORM DIRECTIONAL VELOCITY | PLUCS2441009S-CDCL | 20 |
| 3D | 3" MINI STORM DIRECTIONAL VELOCITY | PLUCS2442009SS-CDCL | 6 |
| 4D | 4" POLY STORM DIRECTIONAL VELOCITY | PLUCS2443009SS-CDCL | 6 |
| 4R | 4" POLY STORM ROTO VELOCITY | PLUCS2443029SS-CDCL | 6 |
| 5MM | 5" POWER STORM MULTI MESSAGE VELOCITY | PLUCS2444059S-CDCL | 2 |
| 5T | 5" ADJUSTABLE WHIRLPOOL VELOCITY WITH VALVE | PLUCS2394009S-CDCL | 1 |
| D2 | VELOCITY 2" WATER DIVERTER VALVE | PLUCS6053309-CDCL | 1 |
| A | VELOCITY AIR CONTROL VALVE | PLUCS6603709-CDCL | 3 |
| W | LED WATERFALL | | 1 |
| FLT | 50 SQ. FT. BIO-CLEAN FILTER WITH TELEWEIR | PLU510-9559-CDCL | 1 |
| M/D | MAIN DRAIN | PLU644-5219-CDCL V | 2 |
| XY-P | TEXTURED Y-PILLOW | | 3 |
| C | TP700 | | 1 |
| OZ | PURE SILK OZONATOR WITH MAZZIE INJECTOR AND MIXING CHAMBER | | 1 |
| L | 5" MULTI COLORED LED LIGHT | | 1 |
| * | PERIMETER LED LIGHTING | | 1 |

| OPTIONS | | |
|---------|--|---------------|
| SYMB. | DESCRIPTION | OPTION NUMBER |
| ATS | EXCLUSIVE ADJUSTABLE THERAPY SYSTEM PLUS (ATS PLUS) | OPT23-109 |
| OZ2 | TWIN PURE SILK SYSTEM DIAL OZONATORS WITH MAZZIE INJECTORS AND MIXING CHAMBERS | OPT23-102DX-1 |
| | CAL SPAS SALT SYSTEM | OPT23-113S |
| - | PURE CURE UV PURIFICATION SYSTEM | OPT23-191B |
| | 24/7 FILTRATION SYSTEM | OPT23-112C |
| FOY | FOUNTAIN OF YOUTH SYSTEM | OPT23-FOY |
| - | ABS MOLDED BOTTOM TRAY | OPT23-990-7 |
| - | CAL CONNECT RF MODULE | OPT23-168RF |
| - | ELITE HORIZONTAL CABINET PANELS AND BLACK BEAM CORNERS (COLORS: GREY, MOCHA, LIME OAK) | OPT23-E981 |
| | FREEDOM SOUND SYSTEM BLUETOOTH, POWERED SUBWOOFER AND 4X SPEAKERS | OPT23-FS43 |
| - | THERMO-GUARD FULL FOAM *THIS OPTION WILL REPLACE THERMO-SHIELD | OPT23-900 |

| | | | |
|--|--------------------|---|---------------------|
| PROPRIETARY AND CONFIDENTIAL THE INFORMATION CONTAINED IN THIS DRAWING IS THE SOLE PROPERTY OF CAL SPAS. ANY REPRODUCTION IN PART OR AS A WHOLE WITHOUT THE WRITTEN PERMISSION OF CAL SPAS IS PROHIBITED. | | CAL SPAS INC. 1442 EAST NINTH STREET, POMONA, CA 91766 | |
| SPECIFICATIONS | | TITLE | JET LAYOUT - STD |
| DIMENSION (in) | 84"x84"x40-1/2" | LINE | ESCAPE |
| DIMENSION (cm) | 213x213x100 | MODEL | 2024 SPA LINE COSTA |
| DRY WEIGHT | 800 LBS [363 Kg] | NUM | EC-740L |
| FILLED WEIGHT | 4340 LBS [1969 Kg] | DWG NO. | CS003009 |
| | | REV | A |
| WATER CAP. | 425 GAL [1609 L] | SCALE | NTS |
| | | | SHEET 1 OF 1 |