

NOTES:
 1. DUE TO OUR CONTINUOUS IMPROVEMENT PROGRAM, ALL MODELS AND SPECIFICATIONS ARE SUBJECT TO CHANGE WITHOUT NOTICE.

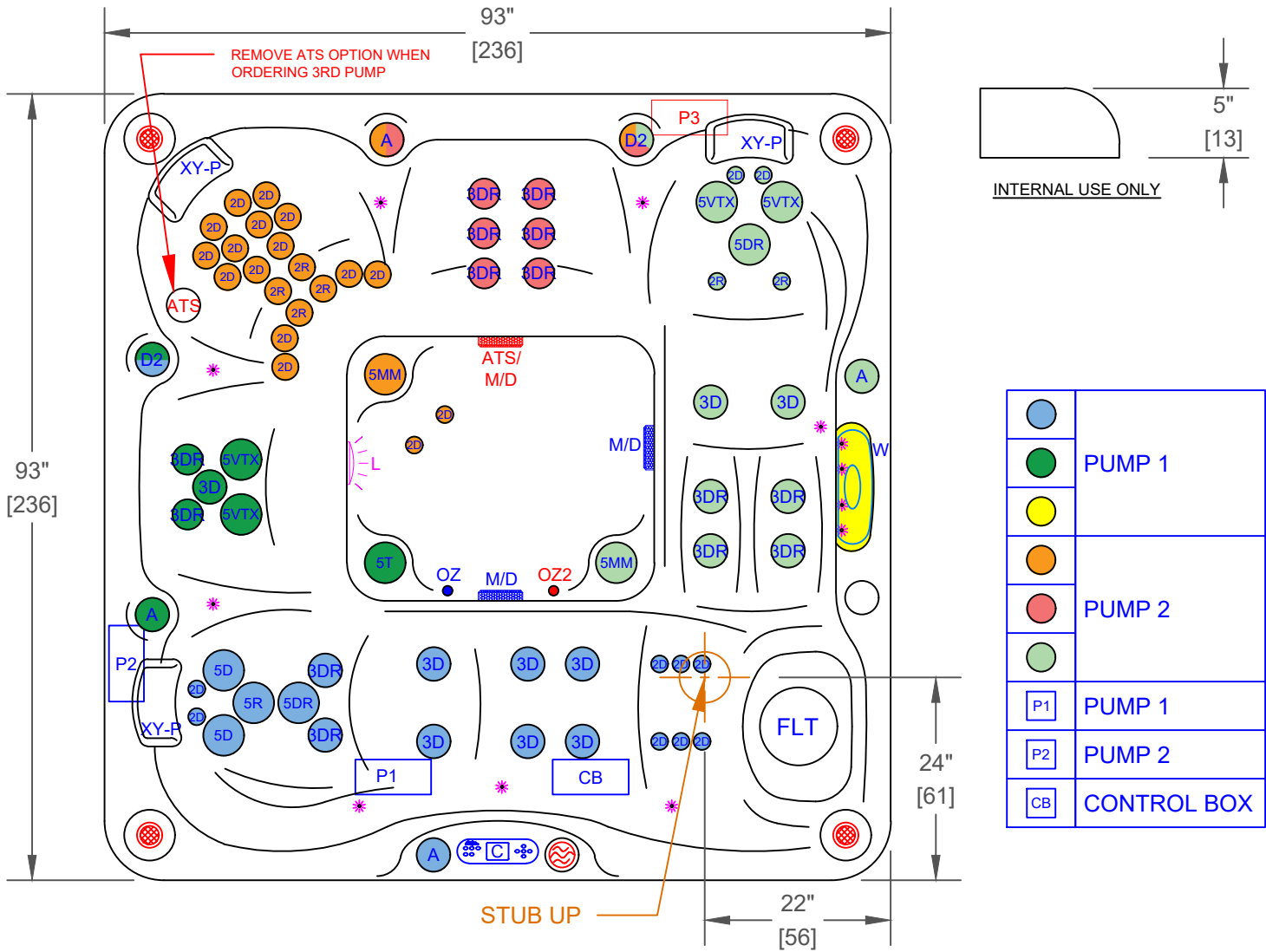

	PUMP 1
	PUMP 2
	PUMP 1
	PUMP 2
	CONTROL BOX

	A	B	C	D
1	EC-867DL - LEGEND			
2	SYMB.	DESCRIPTION	PART NUMBER	QTY.
3	2D	2" CLUSTER STORM DIRECTIONAL VELOCITY	PLUCS2441009S-CDCL	26
4	2R	2" CLUSTER STORM TWIN VELOCITY	PLUCS2441029S-CDCL	6
5	3D	3" MINI STORM DIRECTIONAL VELOCITY	PLUCS2442009SS-CDCL	9
6	3DR	3" MINI STORM TWISTER VELOCITY	PLUCS2442009SS-CDCL	14
7	5D	5" POWER STORM DIRECTIONAL VELOCITY	PLUCS2441009SS-CDCL	2
8	5DR	5" POWER STORM TWISTER VELOCITY	PLUCS2444049S-CDCL	3
9	5VTX	5" POWER STORM TRI DIRECTIONAL VELOCITY	PLUCS2444019S-CDCL	4
10	5MM	5" POWER STORM MULTI MASSAGE VELOCITY	PLUCS2444059S-CDCL	2
11	5T	5" ADJUSTABLE WHIRLPOOL VELOCITY WITH VALVE	PLUCS2394009S-CDCL	2
12	D2	VELOCITY 2" WATER DIVERTER VALVE	PLUCS86053309-CDCL	2
13	A	VELOCITY AIR CONTROL VALVE	PLUCS86603709-CDCL	4
14	W	LED WATERFALL		1
15	FLT	50 SQ. FT. BIO-CLEAN FILTER WITH TELEWEIR	PLU510-9559-CDCL	1
16	M/D	MAIN DRAIN	PLU644-5219-CDCL V	2
17	XY-P	TEXTURED Y-PILLOW		3
18	C	TP700		1
19	OZ2	TWIN PURE SILK™ DUAL OZONATOR WITH MAZZIE INJECTORS AND MIXING CHAMBERS		1
20	L	5" MULTI COLORED LED LIGHT		1
21	*	PERIMETER LED LIGHTING		1

OPTIONS		
SYMB.	DESCRIPTION	OPTION NUMBER
ATS	EXCLUSIVE ADJUSTABLE THERAPY SYSTEM PLUS (ATS PLUS)	OPT23-109
P3	ADDITIONAL 3RD PUMP 1 X 6 BHP (OPTION WILL UPGRADE CONTROL BOX TO BP501X)	OPT23-138B-3P N/A WITH ATS OR 24/7
OZ2	TWIN PURE SILK SYSTEM DIAL OZONATORS WITH MAZZIE INJECTORS AND MIXING CHAMBERS	OPT23-102DX-1
	CAL SPAS SALT SYSTEM	OPT23-113S
-	PURE CURE UV PURIFICATION SYSTEM	OPT23-191B
24/7	24/7 FILTRATION SYSTEM	OPT23-112C
-	ABS MOLDED BOTTOM TRAY	OPT23-990-7
-	CAL CONNECT RF MODULE	OPT23-168RF
-	ELITE HORIZONTAL CABINET PANELS AND BLACK BEAM CORNERS (COLORS: GREY, MOCHA, LIME OAK)	OPT23-E981
	FREEDOM SOUND SYSTEM BLUETOOTH, POWERED SUBWOOFER AND 4X SPEAKERS	OPT23-FS43
-	THERMO-GUARD FULL FOAM	OPT23-900

PROPRIETARY AND CONFIDENTIAL THE INFORMATION CONTAINED IN THIS DRAWING IS THE SOLE PROPERTY OF CAL SPAS. ANY REPRODUCTION IN PART OR AS A WHOLE WITHOUT THE WRITTEN PERMISSION OF CAL SPAS IS PROHIBITED.		 CAL SPAS INC. 1462 EAST NINTH STREET, POMONA, CA 91766	
SPECIFICATIONS		TITLE	JET LAYOUT - STD
DIMENSION (in)	93"x93"x40-1/2"	LINE	ESCAPE
DIMENSION (cm)	236x236x100	MODEL	2023 SPA LINE MALIBU
DRY WEIGHT	900 LBS [408 Kg]	NUM	EC-867DL
FILLED WEIGHT	4650 LBS [2109 Kg]	DWG NO.	CS003073
		REV	A
WATER CAP.	450 GAL [1703 L]	SCALE	NTS
			SHEET 1 OF 1