

NOTES:  
 1. DUE TO OUR CONTINUOUS IMPROVEMENT PROGRAM, ALL MODELS AND SPECIFICATIONS ARE SUBJECT TO CHANGE WITHOUT NOTICE.

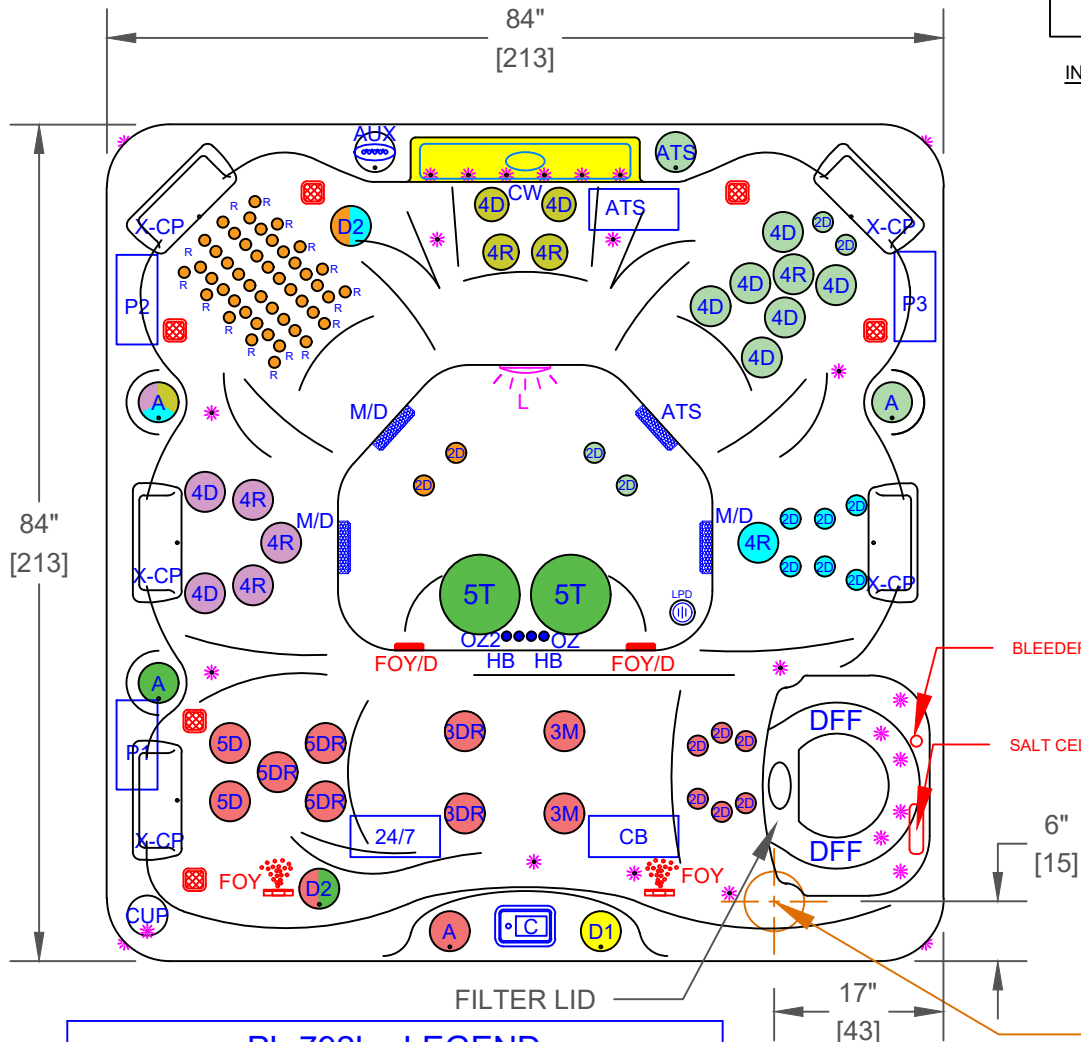
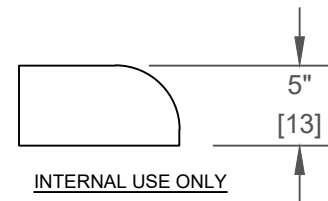

	PUMP 1
	PUMP 2
	PUMP 3
	ATS
	PUMP 1
	PUMP 2
	PUMP 3
	PUMP ATS
	PUMP 24/7
	CONTROL BOX

### PL-792L - LEGEND

SYMB.	DESCRIPTION	PART NUMBER	QTY.
R	RAIN JET	PLU23028-392-000	46
2D	2" CLUSTER STORM DIRECTIONAL VELOCITY	PLUCS2441009S-CDCL	18
3M	3" MINI STORM MULTI MASSAGE	PLUCS2442059S-CDCL	2
3DR	3" MINI STORM TWISTER VELOCITY	PLUCS2443009S-CDCL	2
4D	4" POLY STORM DIRECTIONAL VELOCITY	PLUCS2443009S-CDCL	10
4R	4" POLY STORM ROTO VELOCITY	PLUCS2443029S-CDCL	7
5D	5" POWER STORM DIRECTIONAL VELOCITY	PLUCS2441009S-CDCL	2
5DR	5" POWER STORM TWISTER VELOCITY	PLUCS2444049S-CDCL	3
5T	5" ADJUSTABLE WHIRLPOOL VELOCITY WITH VALVE	PLUCS2394009S-CDCL	2
ATS+	ADJUSTABLE THERAPY SYSTEM +		1
D1	VELOCITY 1" WATER DIVERTER VALVE	PLUCS6054309-CDCL	1
D2	VELOCITY 2" WATER DIVERTER VALVE (UNDERWATER)	PLUCS6053509-CDCL	2
A	VELOCITY AIR CONTROL VALVE	PLUCS6603709-CDCL	4
CW	20" CASCADE LED WATERFALL		1
DFF	150 SQ. FT. DYNA FLOW FILTER (2X 75 SQ. FT.)	PLUCS510-9559-CDCL	2
M/D	MAIN DRAIN	PLU644-5219-CDCL V	4
X-CP	TEXTURED CASCADE PILLOW		5
C	TOUCH CONTROL+ WITH AUX PANEL		1
24/7	24/7 FILTRATION SYSTEM		1
O22	TWIN PURE SILK SYSTEM DIAL OZONATORS WITH MAZZIE INJECTORS AND MIXING CHAMBERS		1
CUP	LED CUP HOLDER		1
LPD	LOW PROFILE DRAIN		1
	BEAM-LITE 4X CABINET CORNER LED LIGHTING		1
L	MULTI COLORED LED LIGHT		1
	PERIMETER LED LIGHTING		1
-	FILTER LID PLATINUM		1

### OPTIONS

SYMB.	DESCRIPTION	OPTION NUMBER
	CAL SPAS SALT SYSTEM	OPT23-113S
-	PURE CURE UV PURIFICATION SYSTEM	OPT23-191B
FOY	FOUNTAIN OF YOUTH SYSTEM	OPT23-FOY
-	PREMIUM HORIZONTAL CABINET PANELS COLORS: TEAK, WEATHERED WHITE	OPT23-E982C
-	VICTORY ELITE LED CORNER UPGRADE	OPT23-967VE-O
-	ABS MOLDED BOTTOM TRAY	OPT23-990-7
-	CAL GRIP DECKING (FLOOR & STEPS)	OPT23-CGPL792L
	FREEDOM SOUND SYSTEM BLUETOOTH, POWERED SUBWOOFER AND 6X SPEAKERS	OPT23-FS62
-	THERMO-GUARD FULL FOAM	OPT23-900

<small>PROPRIETARY AND CONFIDENTIAL</small> <small>THE INFORMATION CONTAINED IN THIS DRAWING IS THE SOLE PROPERTY OF CAL SPAS. ANY REPRODUCTION IN PART OR AS A WHOLE WITHOUT THE WRITTEN PERMISSION OF CAL SPAS IS PROHIBITED.</small>		 <small>CAL SPAS INC.</small> <small>1462 EAST NINTH STREET, POMONA, CA 91766</small>	
SPECIFICATIONS		TITLE	JET LAYOUT - STD
DIMENSION (in)	84"x84"x40-1/2"	LINE	PLATINUM
DIMENSION (cm)	213x213x100	MODEL	2024 SPA LINE HUNTINGTON
DRY WEIGHT	850 LBS [386 Kg]	NUM	PL-792L
FILLED WEIGHT	4390 LBS [1991 Kg]	DWG NO.	CS003088
		REV	A
WATER CAP.	425 GAL [1609 L]	SCALE	NTS
			SHEET 1 OF 1