

NOTES:
 1. DUE TO OUR CONTINUOUS IMPROVEMENT PROGRAM, ALL MODELS AND SPECIFICATIONS ARE SUBJECT TO CHANGE WITHOUT NOTICE.

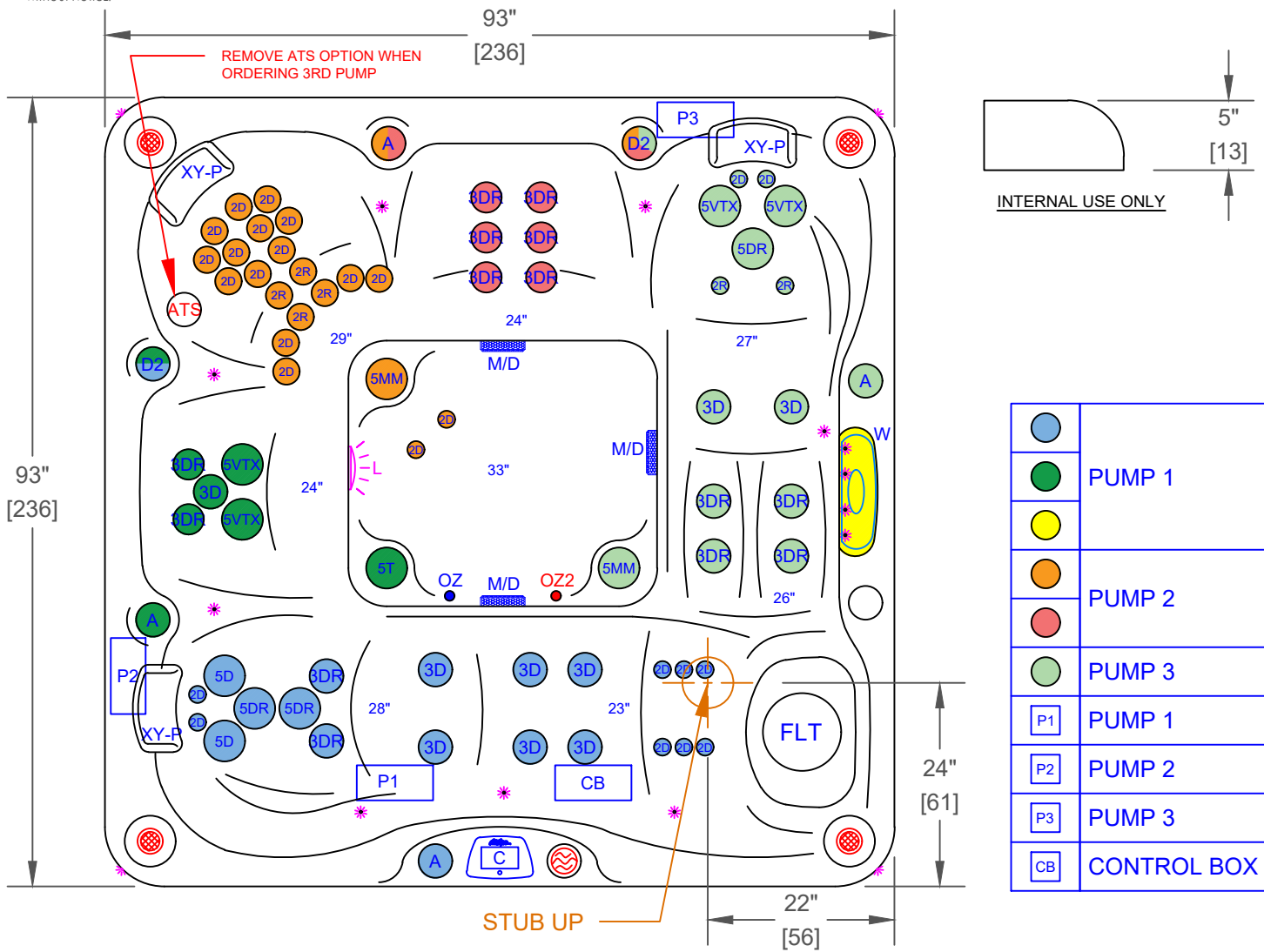

	PUMP 1
	PUMP 2
	PUMP 3
	PUMP 1
	PUMP 2
	PUMP 3
	PUMP 1
	PUMP 2
	PUMP 3
	CONTROL BOX

EC-867DLX - LEGEND

SYMB.	DESCRIPTION	PART NUMBER	QTY.
2D	2" CLUSTER STORM DIRECTIONAL VELOCITY	PLUCS2441009S-CDCL	26
2R	2" CLUSTER STORM TWIN VELOCITY	PLUCS2441029S-CDCL	6
3D	3" MINI STORM DIRECTIONAL VELOCITY	PLUCS2442009SS-CDCL	9
3DR	3" MINI STORM TWISTER VELOCITY	PLUCS2442009SS-CDCL	14
5D	5" POWER STORM DIRECTIONAL VELOCITY	PLUCS2441009SS-CDCL	2
5DR	5" POWER STORM TWISTER VELOCITY	PLUCS2444049S-CDCL	3
5VTX	5" POWER STORM TRI DIRECTIONAL VELOCITY	PLUCS2444019S-CDCL	4
5MM	5" POWER STORM MULTI MASSAGE VELOCITY	PLUCS2444059S-CDCL	2
5T	5" ADJUSTABLE WHIRLPOOL VELOCITY WITH VALVE	PLUCS2394009S-CDCL	2
D2	VELOCITY 2" WATER DIVERTER VALVE	PLUCS6053309-CDCL	2
A	VELOCITY AIR CONTROL VALVE	PLUCS6603709-CDCL	4
W	LED WATERFALL		1
FLT	50 SQ. FT. BIO-CLEAN FILTER WITH TELEWEIR	PLU510-9559-CDCL	1
M/D	MAIN DRAIN	PLU644-5219-CDCL V	2
X-YP	TEXTURED Y-PILLOW		3
C	CAL SPAS TOUCH 2		1
OZ	PURE SILK OZONATOR WITH MAZZIE INJECTOR AND MIXING CHAMBER		1
	BEAM-LITE 4X CABINET CORNER LED LIGHTING		1
	5" MULTI COLORED LED LIGHT		1
	PERIMETER LED LIGHTING		1

OPTIONS

SYMB.	DESCRIPTION	OPTION NUMBER
ATS	EXCLUSIVE ADJUSTABLE THERAPY SYSTEM PLUS (ATS PLUS)	OPT23-109
	OZ2 TWIN PURE SILK SYSTEM DIAL OZONATORS WITH MAZZIE INJECTORS AND MIXING CHAMBERS	OPT23-102DX-1
	CAL SPAS SALT SYSTEM	OPT23-113S
-	PURE CURE UV PURIFICATION SYSTEM	OPT23-191B
	24/7 FILTRATION SYSTEM	OPT23-112C
FOY	FOUNTAIN OF YOUTH SYSTEM	OPT23-FOY
-	PREMIUM HORIZONTAL CABINET PANELS COLORS: TEAK, WEATHERED WHITE	OPT23-E982C
-	VICTORY ELITE LED CORNER UPGRADE	OPT23-967VE-O
-	ABS MOLDED BOTTOM TRAY	OPT23-990-8
-	CAL CONNECT RF MODULE	OPT23-168RF
	FREEDOM SOUND SYSTEM BLUETOOTH, POWERED SUBWOOFER AND 4X SPEAKERS	OPT23-FS43
-	THERMO-GUARD FULL FOAM	OPT23-900

<small>PROPRIETARY AND CONFIDENTIAL</small> THE INFORMATION CONTAINED IN THIS DRAWING IS THE SOLE PROPERTY OF CAL SPAS. ANY REPRODUCTION IN PART OR AS A WHOLE WITHOUT THE WRITTEN PERMISSION OF CAL SPAS IS PROHIBITED.		 CAL SPAS INC. 1462 EAST NINTH STREET, POMONA, CA 91766	
SPECIFICATIONS		TITLE	JET LAYOUT - 113S
DIMENSION (in)	93"x93"x40-1/2"	LINE	ESCAPE X-SERIES
DIMENSION (cm)	236x236x100	MODEL	2024 SPA LINE MALIBU
DRY WEIGHT	900 LBS [408 Kg]	NUM	EC-867DLX
FILLED WEIGHT	4650 LBS [2109 Kg]	DWG NO.	CS003076
		REV	A
WATER CAP.	450 GAL [1703 L]	SCALE	NTS
			SHEET 1 OF 1