

NOTES:
 1. DUE TO OUR CONTINUOUS IMPROVEMENT PROGRAM, ALL MODELS AND SPECIFICATIONS ARE SUBJECT TO CHANGE WITHOUT NOTICE.

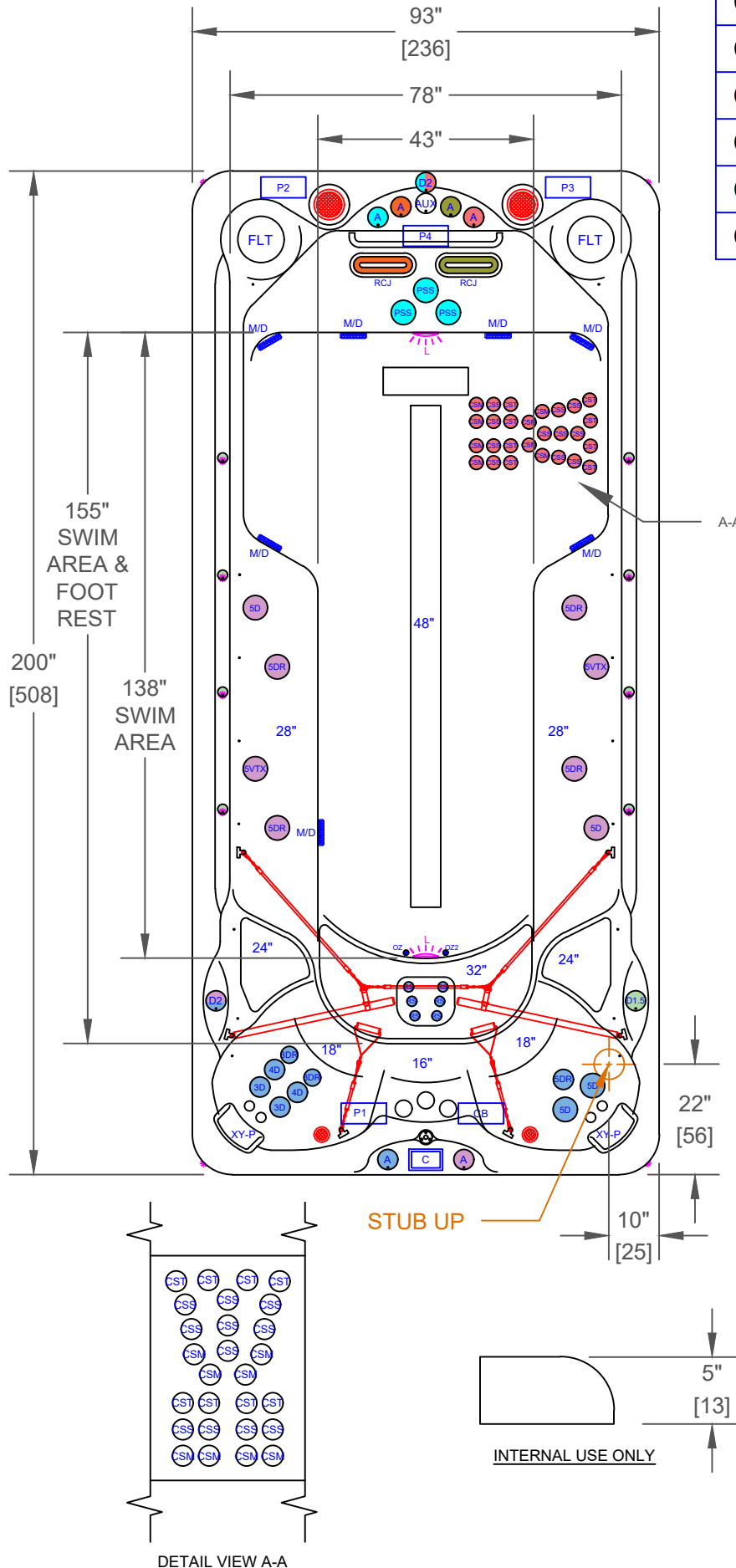

	PUMP 1
	PUMP 2
	PUMP 3
	PUMP 4

	PUMP 1
	PUMP 2
	PUMP 3
	PUMP 4
	CONTROL BOX

F-1655X - LEGEND

SYMB.	DESCRIPTION	PART NUMBER	QTY.
RS	RAIN JET STRAIGHT	PLU23028-292-00	6
3D	3" MINI STORM DIRECTIONAL VELOCITY	PLUCS2442009SS-CDCL	2
3DR	3" MINI STORM TWISTER VELOCITY	PLUCS2442009SS-CDCL	2
4D	4" POLY STORM DIRECTIONAL VELOCITY	PLUCS2443009SS-CDCL	2
5D	5" POWER STORM DIRECTIONAL VELOCITY	PLUCS2441009SS-CDCL	4
5DR	5" POWER STORM TWISTER VELOCITY	PLUCS2444049S-CDCL	5
5VTX	5" POWER STORM TRI DIRECTIONAL VELOCITY	PLUCS2444019S-CDCL	2
CSS	CLUSTER STORM AIR MAX SOLO-STREAM	PLU239-8908S-HLG	11
CST	CLUSTER STORM AIR MAX TRI-STREAM	PLU239-8918S-HLG	8
CSM	CLUSTER STORM AIR MAX MULTI-STREAM	PLU239-8928S-HLG	8
RCJ	RIP CURRENT JETS	PLU210-5168S-DSG	2
PSS	POWER STREAM JETS	PLU210-0821S	3
D2	VELOCITY 2" WATER DIVERTER VALVE	PLUCS6053309-CDCL	2
A	VELOCITY AIR CONTROL VALVE	PLUCS6603709-CDCL	6
-	27" STAINLESS STEEL HANDRAIL		1
FLT	50 SQ. FT. BIO-CLEAN FILTER WITH TELEWEIR	PLU510-9559-CDCL	2
M/D	MAIN DRAIN	PLU644-5219-CDCL V	7
TH	TETHER ANCHOR		1
EA	FITNESS ANCHOR		6
XY-P	TEXTURED Y-PILLOW		2
C	CAL SPAS TOUCH 4		1
OZ2	TWIN PURE SILK™ DUAL OZONATOR WITH MAZZIE INJECTORS AND MIXING CHAMBERS		1
-	LED DUAL HYDRO-STREAMERS PLUS™ WITH D1.5 VALVE		1
	BEAM-LITE 4X CABINET CORNER LED LIGHTING		1
L	5" MULTI COLORED LED LIGHT		2

OPTIONS

SYMB.	DESCRIPTION	OPTION NUMBER
-	PURE CURE UV PURIFICATION SYSTEM	OPT23-191B
-	PREMIUM HORIZONTAL CABINET PANELS COLOR: TEAK, WEATHERED WHITE	OPT23-E982C-2
-	CAL GRIP DECKING (FLOOR & STEPS)	OPT23-CG1655-SBB
-	CAL CONNECT RF MODULE	OPT23-168RF
	FREEDOM SOUND SYSTEM BLUETOOTH, POWERED SUBWOOFER AND 4X SPEAKERS (2X 3" BLACK 2X 6" WHITE)	OPT23-FS622
-	THERMO-GUARD FULL FOAM (THIS OPTION ILL REPLACE THERMO LAYER)	OPT23-900-XL-6A

<small>PROPRIETARY AND CONFIDENTIAL</small> THE INFORMATION CONTAINED IN THIS DRAWING IS THE SOLE PROPERTY OF CAL SPAS. ANY REPRODUCTION IN PART OR AS A WHOLE WITHOUT THE WRITTEN PERMISSION OF CAL SPAS IS PROHIBITED.		 <small>CAL SPAS INC. 1462 EAST NINTH STREET, POMONA, CA 91766</small>	
SPECIFICATIONS		TITLE	JET LAYOUT - STD
DIMENSION (in)	93"x200"x51"	LINE	SWIM-PRO
DIMENSION (cm)	236x508x130	MODEL	2024 SPA LINE COMMANDER X-SERIES
DRY WEIGHT	2850 LBS [1293 Kg]	NUM	F-1655X
FILLED WEIGHT	23700 LBS [10750 Kg]	DWG NO.	CS003086
WATER CAP.	2500 GAL [9463 L]	SCALE	NTS
		REV	A
		SHEET 1 OF 1	

DETAIL VIEW A-A