

LINE	PATIO PLUS
MODEL	VISTA
NUM	PPZ-628T

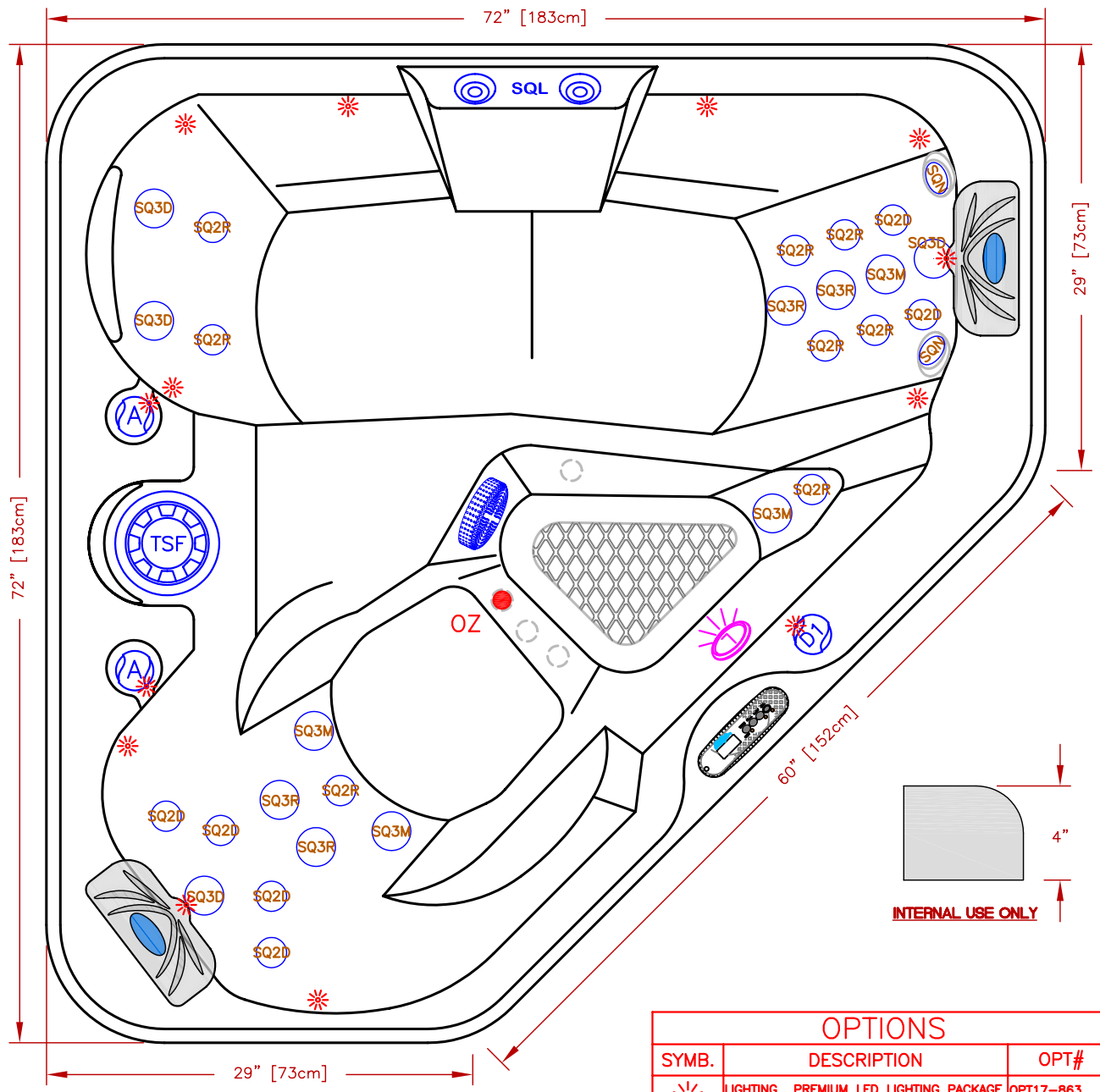

28 JETS LEGEND			
QTY.	SYMB.	DESCRIPTION	PART#
2	(SQN)	NECK JET DIRECTIONAL 100%	PLU29520-611-500
6	(SQ2D)	EURO DIRECTIONAL,-BLK	PLU29520-011-500
8	(SQ2R)	PULSATE JET/HAND JET	PLU29520-021-500
4	(SQ3D)	MINI-JET DIRECTIONAL	PLU29530-111-500
4	(SQ3M)	MINI-JET MASSAGE	PLU29530-141-500
4	(SQ3R)	ROTO	PLU29530-121-500
1	(SQL)	DUAL HYDRO STREAMER W/VALVE	
2	(A)	AIR VALVE	
1	(M/D)	MAIN DRAIN	
1	(F)	50 SQ.FT. FILTER TELEWEIR	
1	(L)	MULTI COLORED LED	
2	(P)	C-PILLOWS	
1	(CONTROL)	TP400U LCD TOPSIDE	

OPTIONS		
SYMB.	DESCRIPTION	OPT#
	LIGHTING PREMIUM LED LIGHTING PACKAGE JET, CASCADE PILLOW VALVE LED LIGHTING	OPT17-863 OPT17-JVP831
	PURE SILK OZONE W/MAZZIE INJECTOR	OPT17-102C
	HYBRID SYSTEM+PURE UV+CURE OZONE	OPT17-193H
	CAL SPAS Wi-Fi Module	OPT17-WI-FI

SPECIFICATIONS		
DIMENSIONS (IN) 72" X 72" X 36" DIMENSIONS (CM) 183 X 183 X 91 WATER CAP. 130GAL / 492L APP. WEIGHT 600LBS / 272 Kg		
TITLE 2017 SPA LINE PATIO PLUS SERIES PPZ-628T		
DWG BY G.GARCIA	DATE 11/14/16	
REV DESCRIPTION	REV No.	

NOTE: DUE TO OUR CONTINUOUS IMPROVEMENT PROGRAM, ALL MODELS AND SPECIFICATIONS ARE SUBJECT TO CHANGE WITHOUT NOTICE.

SCALE: