

NOTES:  
 1. DUE TO OUR CONTINUOUS IMPROVEMENT PROGRAM, ALL MODELS AND SPECIFICATIONS ARE SUBJECT TO CHANGE WITHOUT NOTICE.

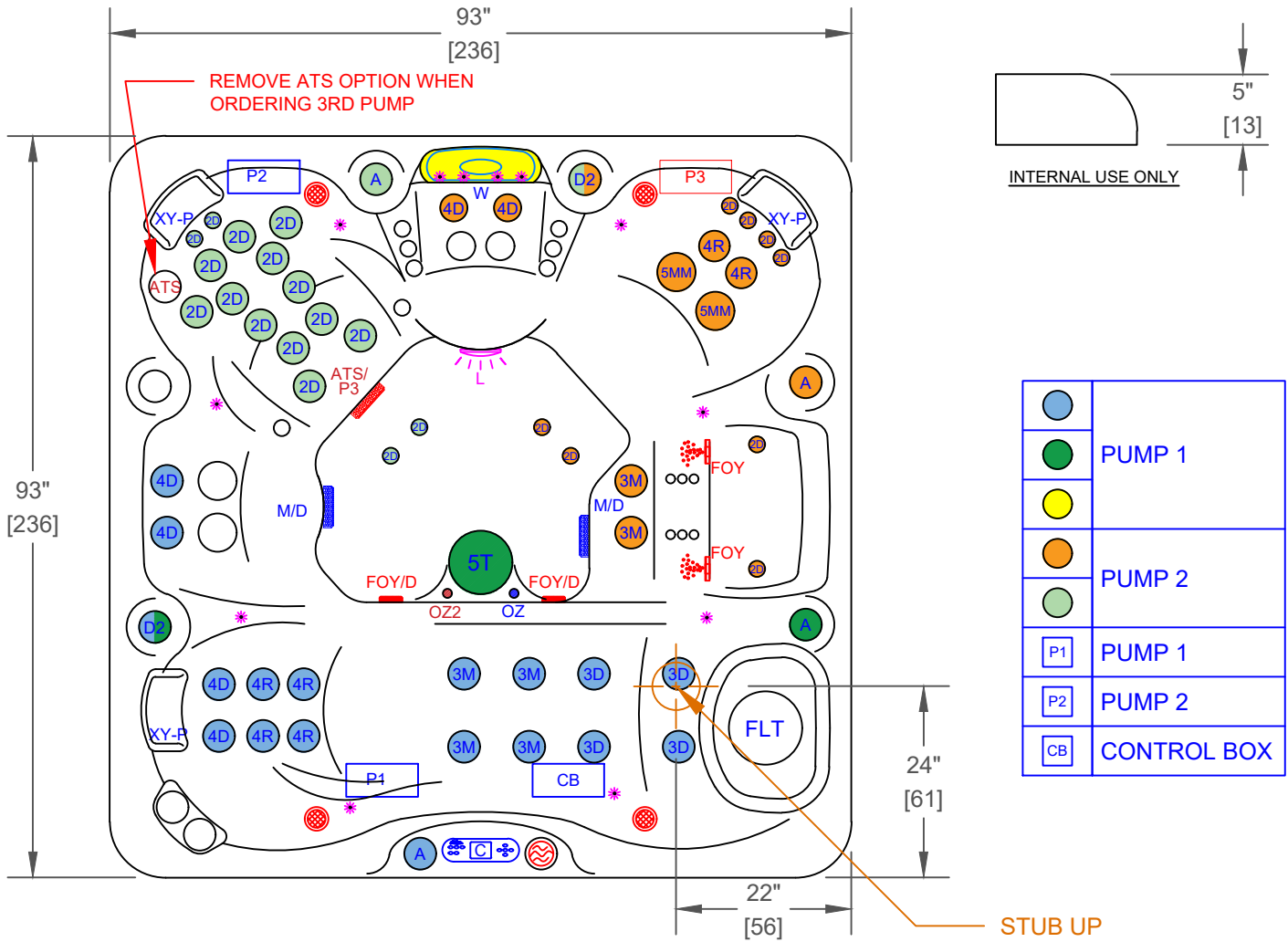

EC-849L - LEGEND			
SYMB.	DESCRIPTION	PART NUMBER	QTY.
2D	2" CLUSTER STORM DIRECTIONAL VELOCITY	PLUCS2441009S-CDCL	24
3D	3" MINI STORM DIRECTIONAL VELOCITY	PLUCS2442009SS-CDCL	4
3M	3" MINI STORM MESSAGE DIRECTIONAL VELOCITY	PLUCS2442059S-CDCL	6
4D	4" POLY STORM DIRECTIONAL VELOCITY	PLUCS2443009SS-CDCL	6
4R	4" POLY STORM ROTO VELOCITY	PLUCS2443029SS-CDCL	6
5MM	5" POWER STORM MULTI MESSAGE VELOCITY	PLUCS2444059S-CDCL	2
5T	5" ADJUSTABLE WHIRLPOOL VELOCITY WITH VALVE	PLUCS2394009S-CDCL	1
D2	VELOCITY 2" WATER DIVERTER VALVE	PLUCS8053309-CDCL	2
A	VELOCITY AIR CONTROL VALVE	PLUCS86603709-CDCL	4
W	LED WATERFALL		1
FLT	50 SQ. FT. BIO-CLEAN FILTER WITH TELEWEIR	PLU510-9559-CDCL	1
M/D	MAIN DRAIN	PLU644-5219-CDCL V	2
XY-P	TEXTURED Y-PILLOW		4
C	TP700		1
OZ	PURE SILK OZONATOR WITH MAZZIE INJECTOR AND MIXING CHAMBER		1
L	5" MULTI COLORED LED LIGHT		1
*	PERIMETER LED LIGHTING		1

OPTIONS		
SYMB.	DESCRIPTION	OPTION NUMBER
ATS	EXCLUSIVE ADJUSTABLE THERAPY SYSTEM PLUS (ATS PLUS)	OPT23-109
P3	ADDITIONAL 3RD PUMP 1 X 6 BHP (OPTION WILL UPGRADE CONTROL BOX TO BP501X)	OPT23-138B-3P N/A WITH ATS OR 24/7
OZ2	TWIN PURE SILK SYSTEM DIAL OZONATORS WITH MAZZIE INJECTORS AND MIXING CHAMBERS	OPT23-102DX-1
⊗	CAL SPAS SALT SYSTEM	OPT23-113S
-	PURE CURE UV PURIFICATION SYSTEM	OPT23-191B
24/7	24/7 FILTRATION SYSTEM	OPT23-112C
FOY	FOUNTAIN OF YOUTH SYSTEM	OPT23-FOY
-	ABS MOLDED BOTTOM TRAY	OPT23-990-8
-	CAL CONNECT RF MODULE	OPT23-168RF
⊗	FREEDOM SOUND SYSTEM BLUETOOTH, POWERED SUBWOOFER AND 4X SPEAKERS	OPT23-FS43
-	THERMO-GUARD FULL FOAM	OPT23-900

PROPRIETARY AND CONFIDENTIAL THE INFORMATION CONTAINED IN THIS DRAWING IS THE SOLE PROPERTY OF CAL SPAS. ANY REPRODUCTION IN PART OR AS A WHOLE WITHOUT THE WRITTEN PERMISSION OF CAL SPAS IS PROHIBITED.		 CAL SPAS INC. 1442 EAST NINTH STREET, POMONA, CA 91766	
SPECIFICATIONS		TITLE	JET LAYOUT - 113S
DIMENSION (in)	93"x93"x40-1/2"	LINE	ESCAPE
DIMENSION (cm)	236x236x100	MODEL	2023 SPA LINE AVALON
DRY WEIGHT	900 LBS [408 Kg]	NUM	EC-849L
FILLED WEIGHT	4650 LBS [2109 Kg]	DWG NO.	CS002491
WATER CAP.	450 GAL [1703 L]	SCALE	NTS
		REV	B
		SHEET 1 OF 1	