

NOTES:  
 1. DUE TO OUR CONTINUOUS IMPROVEMENT PROGRAM, ALL MODELS AND SPECIFICATIONS ARE SUBJECT TO CHANGE WITHOUT NOTICE.

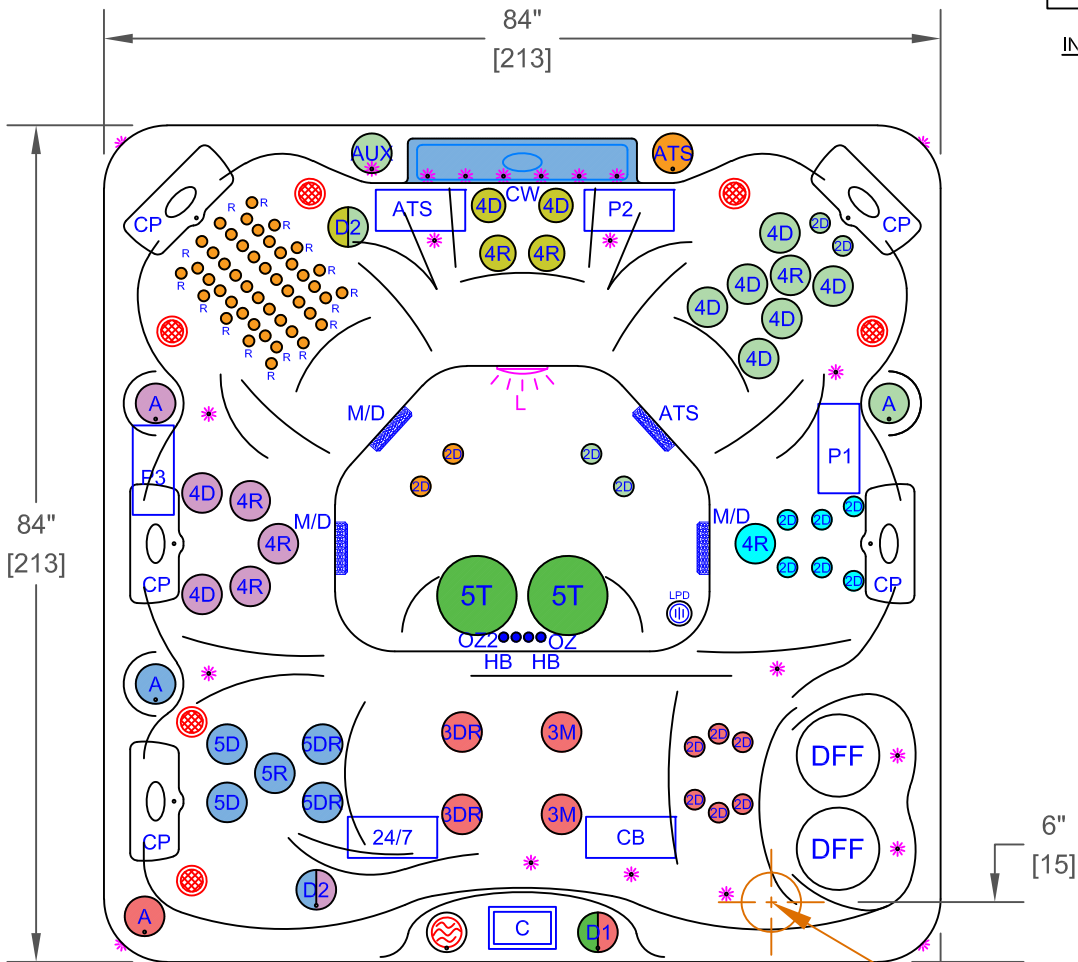
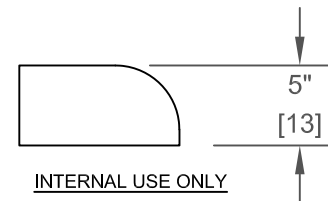

	PUMP 1
	PUMP 2
	PUMP 3
	ATS
	PUMP 1
	PUMP 2
	PUMP 3
	PUMP 1
	PUMP 2
	PUMP 3
	PUMP ATS
	PUMP 24/7
	CONTROL BOX

**PL-792L - LEGEND**

SYMB.	DESCRIPTION	PART NUMBER	QTY.
R	RAIN JET	PLU23028-392-000	46
2D	200 VELOCITY DIRECTIONAL	PLU29920-012-400	18
3M	300 VELOCITY MESSAGE	PLU29930-142-400	2
3DR	300 VELOCITY DOUBLE ROTO	PLU29930-191-400	2
4D	400 VELOCITY DIRECTIONAL	PLU29940-112-400	10
4R	400 VELOCITY ROTO	PLU29940-122-400	7
5D	500 VELOCITY DIRECTIONAL	PLU29950-012-400	2
5R	500 VELOCITY ROTO	PLU29950-081-400	1
5DR	500 VELOCITY DOUBLE ROTO	PLU29950-032-400	2
5T	500 VELOCITY DIRECTIONAL	PLU29950-501-400	2
ATS+	ADJUSTABLE THERAPY SYSTEM +		1
D1	VELOCITY 1" WATER DIVERTER VALVE (UNDERWATER)		1
D2	VELOCITY 2" WATER DIVERTER VALVE	PLU25058-202-800	2
A	VELOCITY AIR CONTROL VALVE	PLU25059-202-400	4
CW	20" CASCADE LED WATERFALL		1
DFF	150 SQ. FT. DYNA FLOW FILTER (2X 75 SQ. FT.)		2
M/D	MAIN DRAIN		2
CP	CASCADE PILLOWS WITH SILVER LOGO		4
C	CAL SPAS TOUCH 4 WITH AUX PANEL		1
OZ	PURE SILK OZONATOR WITH MAZZIE INJECTOR AND MIXING CHAMBER		1
24/7	24/7 FILTRATION SYSTEM		1
OZ2	TWIN PURE SILK SYSTEM DIAL OZONATORS WITH MAZZIE INJECTORS AND MIXING CHAMBERS		1
LPD	LOW PROFILE DRAIN		1
	BEAM-LITE 4X CABINET CORNER LED LIGHTING		1
	MULTI COLORED LED LIGHT		1
	PERIMETER LED LIGHTING		1

**OPTIONS**

SYMB.	DESCRIPTION	OPTION NUMBER
	FREEDOM SOUND SYSTEM BLUETOOTH, POWERED SUBWOOFER AND 4X SPEAKERS	OPT22-FS43
-	THERMO-GUARD FULL FOAM	OPT22-900
	CAL SPAS SALT SYSTEM	OPT22-113S

PROPRIETARY AND CONFIDENTIAL THE INFORMATION CONTAINED IN THIS DRAWING IS THE SOLE PROPERTY OF CAL SPAS. ANY REPRODUCTION IN PART OR AS A WHOLE WITHOUT THE WRITTEN PERMISSION OF CAL SPAS IS PROHIBITED.		 CAL SPAS INC. 1462 EAST NINTH STREET, POMONA, CA 91766	
SPECIFICATIONS		TITLE	JET LAYOUT - 113S
DIMENSION (in)	93"x93"x40-1/2"	LINE	PLATINUM
DIMENSION (cm)	236x236x100	MODEL	2022 SPA LINE HUNTINGTON
DRY WEIGHT	900LBS [408 Kg]	NUM	PL-792L
FILLED WEIGHT	4650 LBS [2109 Kg]	DWG NO.	CS000760
WATER CAP.	450 GAL [1703 L]	SCALE	NTS
		REV	D
		SHEET 1 OF 1	