

|       |         |
|-------|---------|
| LINE  | ESCAPE  |
| MODEL | CANCUN  |
| NUM   | EC-867B |

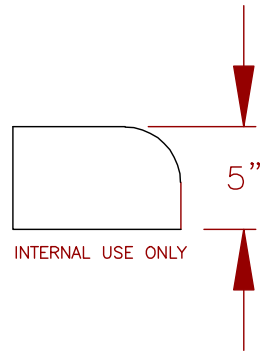
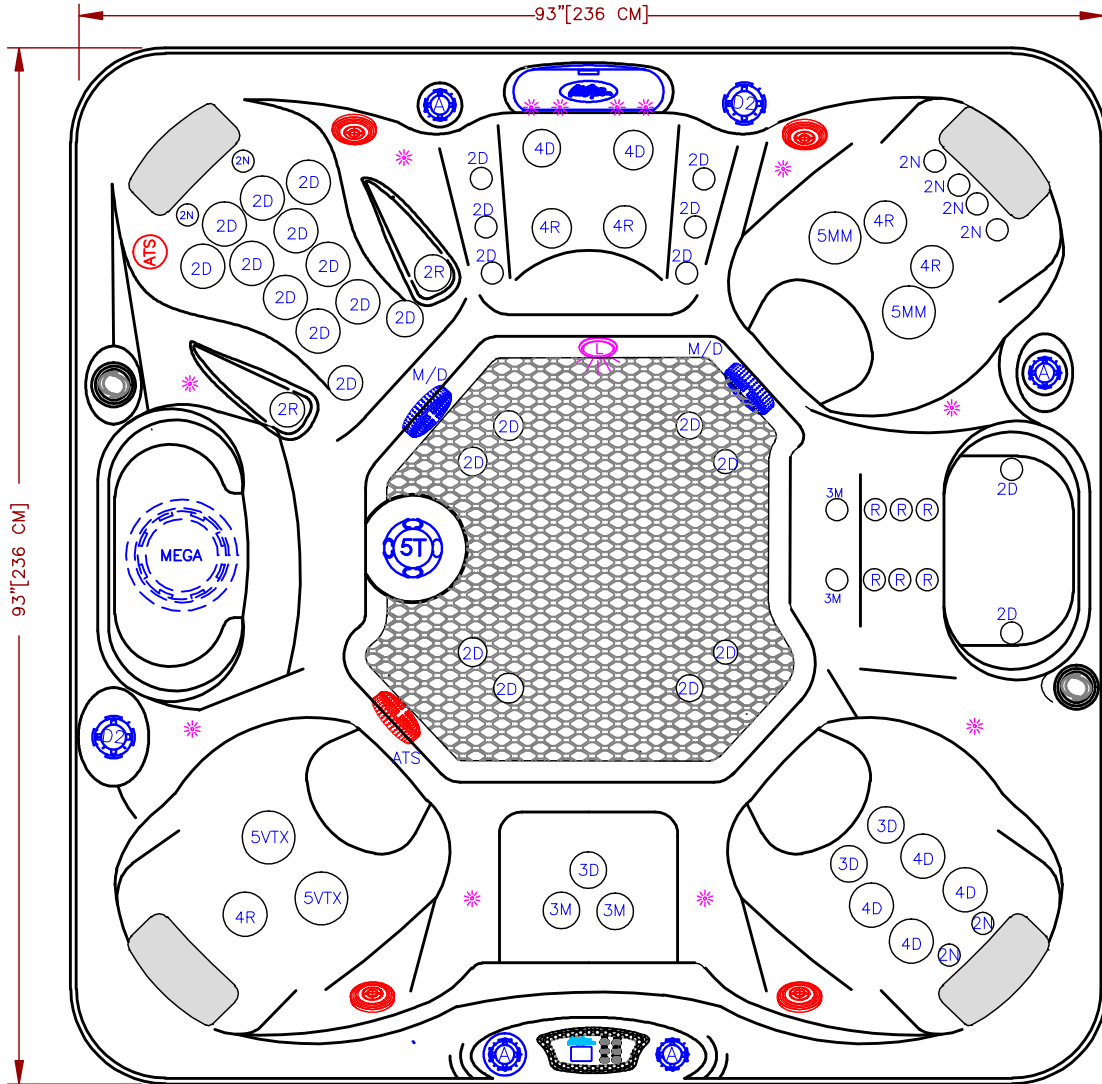

2018  
EC-867B

OPTIONS

| QTY. | SYMB.   | DESCRIPTION                      | PART NUMBER      |
|------|---------|----------------------------------|------------------|
| 6    | R       | Rain Jet                         | PLU23028-292-000 |
| 8    | 2N      | 200 Velocity Neck 100%           | PLU29920-612-400 |
| 28   | 2D      | 200 Velocity Directional         | PLU29920-012-400 |
| 2    | 2R      | 200 Velocity Roto                | PLU29920-022-400 |
| 3    | 3D      | 300 Velocity Directional         | PLU29930-112-400 |
| 4    | 3M      | 300 Velocity Massage             | PLU29930-142-400 |
| 6    | 4D      | 400 Velocity Directional         | PLU29940-112-400 |
| 5    | 4R      | 400 Velocity Roto                | PLU29940-122-400 |
| 2    | 5VTX    | 500 Velocity VTX                 | PLU29950-011-400 |
| 2    | 5MM     | 500 Velocity Massage 14 Port     | PLU29950-071-400 |
| 1    | 5T      | 500 Velocity Tornado/Whirlpool   | PLU29950-501-400 |
| 1    | CWF     | Curved Cascade LED Waterfall     |                  |
| 1    | L       | Premium LED Lighting             |                  |
| 2    | D2      | Velocity 2" Water Diverter Valve | PLU25058-202-400 |
| 4    | A       | Velocity Air Control Valve       | PLU25059-202-400 |
| 1    | F       | 75 Sq. Ft. Filter Megaweir       |                  |
| 2    | M/D     | Main Drain                       |                  |
| 3    | P       | Y-Pillows                        |                  |
| 1    | Control | NEO 1100 Wave                    |                  |

|  |  |              |
|--|--|--------------|
|  | C Lite 2X Front Cabinet Corners                      | OPT18-966L2  |
|  | Jets, Cascade Pillows, Valve LED Lighting            | OPT18-JPV850 |
|  | Pure Silk Ozonator                                   | OPT18-102C   |
|  | Adjustable Therapy System                            | OPT18-109    |
|  | 24/7 Filtration System                               | OPT18-112C   |
|  | Cal Pure Salt System                                 | OPT18-113B   |
|  | Hybrid System + Pure UV+Cure Ozone                   | OPT18-193H   |
|  | NEO Wi-Fi Module                                     | OPT18-WI-FI  |
|  | Freedom Sound Bluetooth Subwoofer<br>W/4-3" Speakers | OPT18-FS43   |

SCALE: N/A

SPECIFICATIONS  
 DIMENSIONS (IN) 93"x93"x40.5"  
 DIMENSIONS (CM) 236X236X100  
 WATER CAP. 450GAL/1703L  
 APP. WEIGHT 2000 LBS [908 Kg]



|  |                      |
|--|----------------------|
| TITLE<br>2018 SPA LINE<br>ESCAPE SPAS<br>EC-867B |                      |
| DWG NO.  | DWG BY<br>J. ORNELAS |
| DATE<br>11/20/17                                 | REVISED              |

NOTE:  
 DUE TO OUR CONTINUOUS IMPROVEMENT PROGRAM, ALL MODELS  
 AND SPECIFICATIONS ARE SUBJECT TO CHANGE WITHOUT NOTICE.