

LINE	ESCAPE PLUS
MODEL	NEWPORTER
NUM	EP-1148L

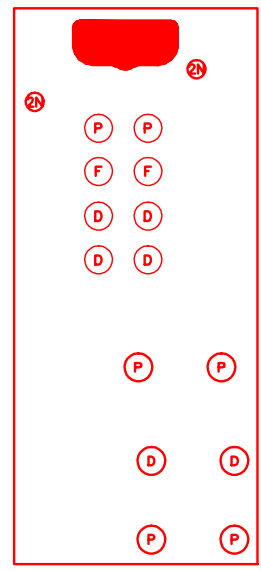
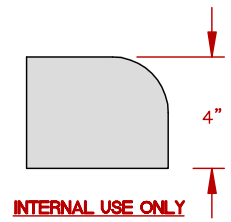
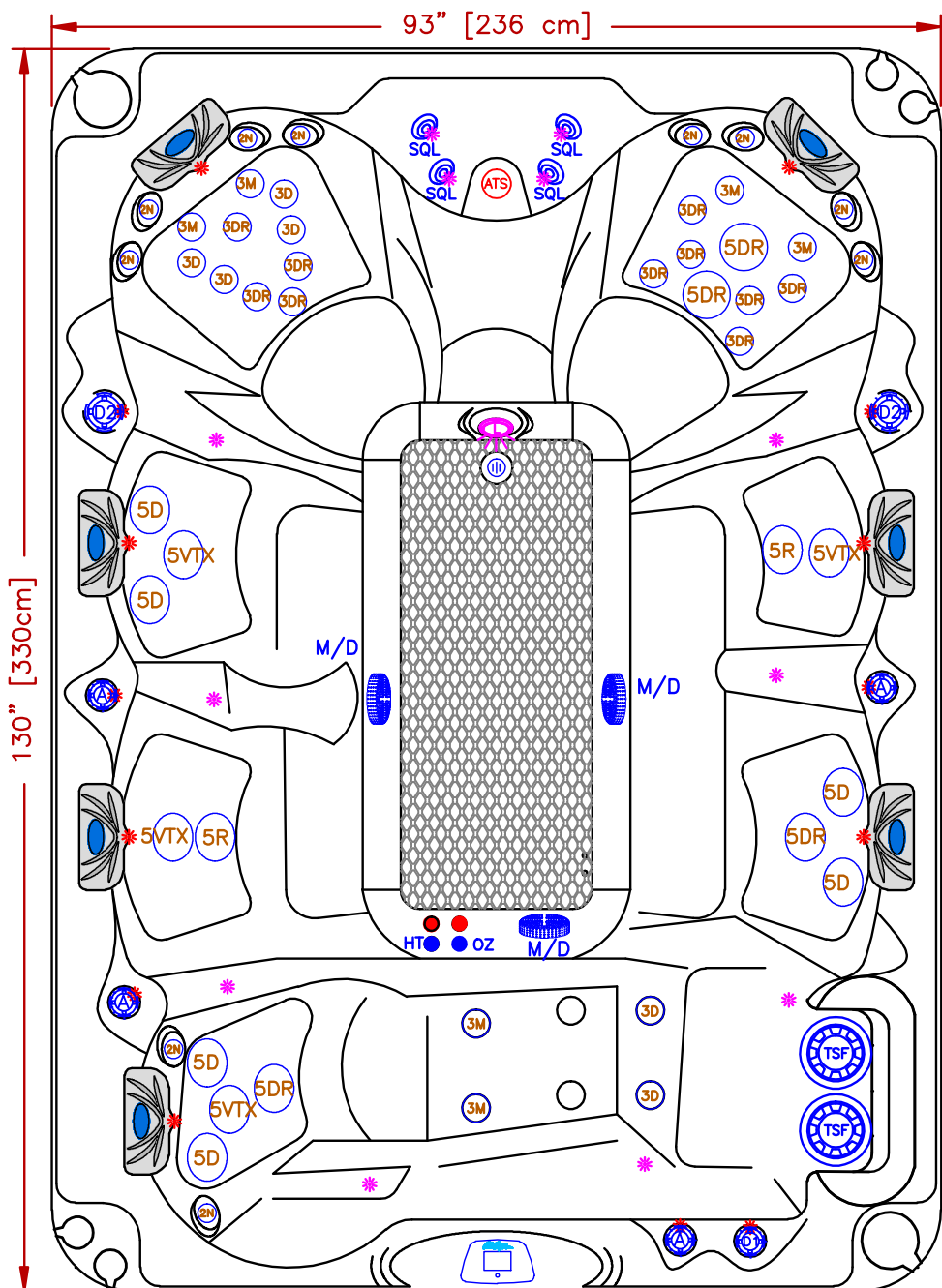

AAT (OPT20-AAT16) SEAT JET LAYOUT

### 48 JETS LEGEND

QTY.	SYMB.	DESCRIPTION	PART#
10	2N	200 VELOCITY NECK 100%	PLU29920-612-400
6	3D	300 VELOCITY DIRECTIONAL	PLU29930-112-400
6	3M	300 VELOCITY MASSAGE	PLU29930-142-400
10	3DR	300 VELOCITY DOUBLE ROTO	PLU29930-191-400
6	5D	500 VELOCITY DIRECTIONAL	PLU29950-012-400
2	5R	500 VELOCITY ROTO	PLU29950-081-400
4	5DR	500 VELOCITY DOUBLE ROTO	PLU29950-032-400
4	5VTX	500 VELOCITY VTX	PLU29950-011-400
2	D2	VELOCITY 2" WATER DIVERTER VALVE	PLU25058-202-400
4	A	VELOCITY AIR CONTROL VALVE	PLU25059-202-400
1	D1	VELOCITY 1" WATER DIVERTER VALVE	PLU25056-202-400
4	SQL	4 LED HYDRO STREAMERS PLUS	PLU210-8508S
1	OZ	PURE SILK OZONATOR	
2	F	2X50 SQ. FT. TELEWEIR FILTER	
1	L	PERIMETER LED LIGHTING	
3	M/D	MAIN DRAIN	
7	P	C-PILLOW	
1	CONTROL	CAL SPAS TOUCH 2	

OPTIONS		
SYMB.	DESCRIPTION	OPT#
	BEAM-LITE™ 4X CABINET CORNERS LED LIGHT JET AND VALVE LED LIGHTING	OPT20-967B4 OPT20-JPV850
AAT	AQUATIC AIR THERAPY (LOUNGER)	OPT20-16
	ADJUSTABLE THERAPY SYSTEM. <small>this option will replace 1x6.0 BHP pump</small>	OPT20-109
	24/7 FILTRATION SYSTEM	OPT20-112C
RF	CAL CONNECT RF MODULE	OPT20-168RF
	FREEDOM SOUND, BLUETOOTH, SUBWOOFER W/4 SPEAKERS	OPT20-FS46
CONTROL	CAL SPA TOUCH3- FULL COLOR 5" LCD TOUCH DISPLAY	OPT20-169-T3
	HYBRID SANITIZING SYSTEM: PURE CURE™ UV+PURE SILK™ OZONE <small>*THIS OPTION WILL REPLACE THE PURE SILK SYSTEM</small>	OPT20-191B
	TWIN PURE SILK™ SYSTEM	OPT20-102D

**SPECIFICATIONS**  
 DIMENSIONS (IN) 93" X 130" X 39.5"  
 DIMENSIONS (CM) 236 X 330 X 100  
 WATER CAP. 800GAL / 3,028L  
 APP. WEIGHT 1200LBS / 544Kg



TITLE  
 2020 SPA LINE  
 ESCAPE PLUS SERIES  
 EP-1148L

DWG BY J. ORNELAS DATE 1/31/20

REV DESCRIPTION REV No.

NOTE: DUE TO OUR CONTINUOUS IMPROVEMENT PROGRAM, ALL MODELS AND SPECIFICATIONS ARE SUBJECT TO CHANGE WITHOUT NOTICE.

SCALE: